

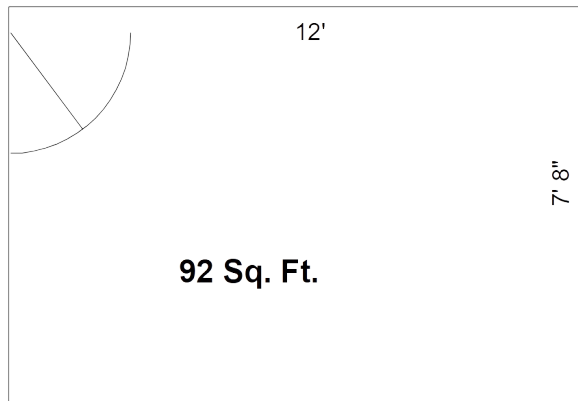

# Manchester Mill<sup>LLC</sup>

201 E. Main St. • PO Box 383 • Manchester, MI 48158

## Office Space: Unit 10



- Established Commercial Center in Downtown Manchester.
- Landmark Location on Scenic Raisin River.
- Exterior Main Street and Directory Signs.
- Convenient private parking.
- External maintenance included (snow removal, lawn care, trash, etc).
- Building centrally heated & air conditioned.
- Tenant restroom.
- High-speed Internet access available.
- Mill Porch and Downstairs Atrium available for special events.
- Refundable security deposit.
- Rental terms & conditions – available upon request.

**Rental Info:** 734-657-3690  
karl@manchestermill.com

Updated: 30-DEC-2020