

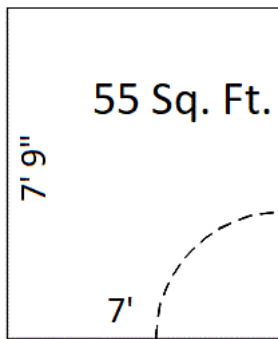

## Retail Space: Unit 3



- Established Commercial Center in Downtown Manchester.
- Landmark Location on Scenic Raisin River.
- High Customer Traffic Main Floor Location.
- Exterior Main Street and Directory Signs.
- Convenient, private parking.
- External maintenance included (snow removal, lawn care, trash, etc).
- Centrally heated & air conditioned building.
- Tenant restroom.
- High-speed Internet access available.
- Mill Porch and Downstairs Atrium available for special events.
- Refundable security deposit.
- Rental terms available upon request.

**Rental Info:** 734-657-3690  
karl@manchestermill.com

(Updated: 21-DEC-2020)